

Embankment Stainless Steel Tube Slide (4.9m)

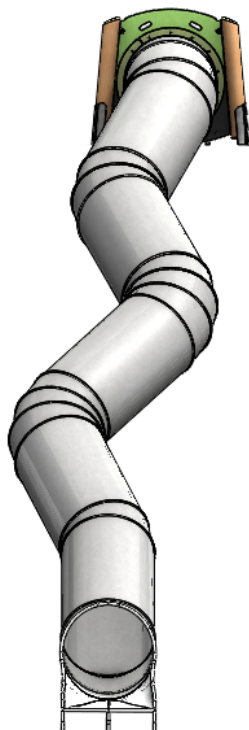

Code – ESTS(49)

Age

3-12 years

Materials

Stainless Steel

Compact Grade

Laminate

Galvanised Mild

Steel

Laminated Timber

Product Description

Stainless Steel Tube Slide mounted to a coloured CGL panel supported by steel mounted laminated poles. The entry section comprises of a textured CGL half-moon deck supported by galvanised steel frames

Technical Information

Equipment Dimensions

Length / Width / Height **10m x 2m x 1.2m**

Surfacing and Area Required

Recommended Minimum Space **13.2m x 4.4m x 2.5m**

Max Gradient of Ground **1 in 1.4**

Free Height of Fall **1.0m**

Impact Area **22.55 m²**

Synthetic Area
(i.e. EPDM / Wetpour / Synthetic Grass etc.) **13.86m²**

Loosefill at 150mm
(i.e. Bark / Cushionfall / Sand) **3m³**

Grasslok Tiles **15m²**

Installation Information

SGF

SF (if different)

Installation Time **2 Person(s) 10 Hour(s)**

Overall Weight **432kg** **00kg**

Heaviest Part **90kg** **00kg**

Largest Part **2.5m x 1.8m x 1.5m** **0.0m x 0.0m x 0.0m**

Longest Part **2.5m** **0.0m**

Concrete Required **1.1m³** **0.0m³**

Certified to EN 1176

[Click here for more information & downloads](#)



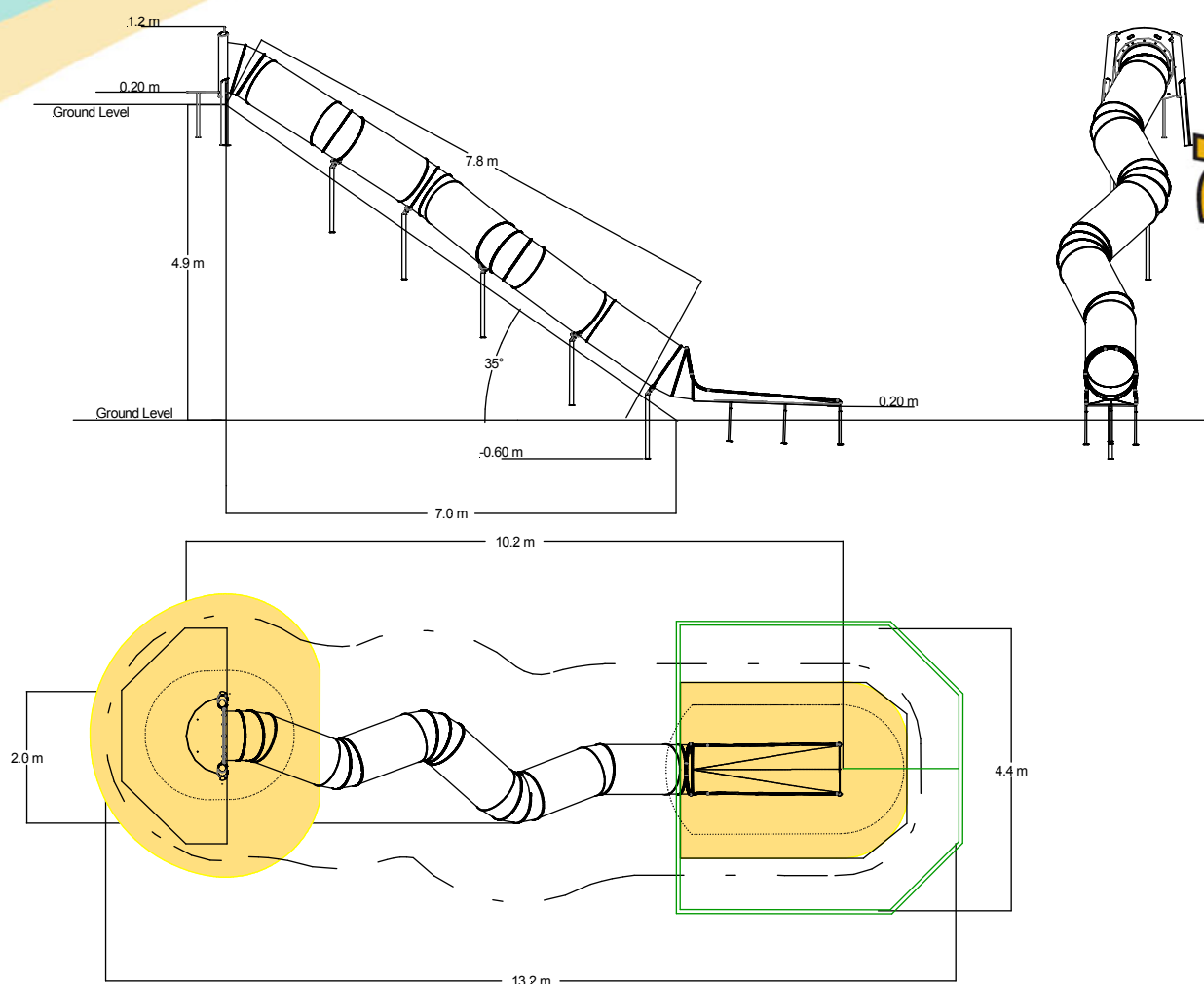

[Click here for more information & downloads](#)

