

Versatile Embankment Slide

Stainless Steel Wide Slide [EM-SW]

Contents

[Versatile Embankment Slide - Tower 0.7m High \[EM-TW0.70\]](#)

[Versatile Embankment Slide - Tower 1.1m High \[EM-TW1.10\]](#)

[Versatile Embankment Slide - Tower 1.5m High \[EM-TW1.50\]](#)

[Versatile Embankment Slide - Stainless Steel Wide 1.5m High \[EM-SW1.50\]](#)

[Versatile Embankment Slide - Stainless Steel Wide 1.7m High \[EM-SW1.70\]](#)

[Versatile Embankment Slide - Stainless Steel Wide 1.9m High \[EM-SW1.90\]](#)

[Versatile Embankment Slide - Stainless Steel Wide 2.1m High \[EM-SW2.10\]](#)

[Versatile Embankment Slide - Stainless Steel Wide 2.3m High \[EM-SW2.30\]](#)

[Versatile Embankment Slide - Stainless Steel Wide 2.5m High \[EM-SW2.50\]](#)

[Versatile Embankment Slide - Stainless Steel Wide 2.7m High \[EM-SW2.70\]](#)

Versatile Embankment Slide

- Tower 0.7m High



Code - EM-TW(0.70)

Age

2-12 years dependent on frame height and slide length

Materials

Stainless Steel

Coloured CGL

Various Coloured Plastics

Product Description

Stainless Steel frame with CGL side panels and platform supported by solid stainless steel adjustable post. Innovative hand and foot steps made from textured CGL are attached to the adjustable post.

Technical Information

Equipment Dimensions

Length / Width / Height 0.7m x 1.04m x 0.5m

Surfacing and Area Required

Recommended Minimum Space L/W/H 4.4m x 4.7m x 3.2m

Max Gradient of Ground 1 in 5 at tower access

Free Height of Fall 0.7m

Impact Area 11.8m²

Synthetic Area (i.e. EPDM / Wet Pour / Synthetic Grass etc.) 11.8m²

Loosefill at 150mm depth (i.e. Bark / Cushionfall / Sand) 3m³

GrassLok Tiles (wear & tear) 2m²

Installation Information

SGF

Installation Time 2 Person(s) 1.5 Hour(s)

Overall Weight 73.5kg

Heaviest Part 13.8kg

Largest Part 0.48m x 1.04m x 0.04m

Longest Part 1.1m

Concrete Required 0.33m³

Conforms to EN 1176

[Click here for more information & downloads](#)



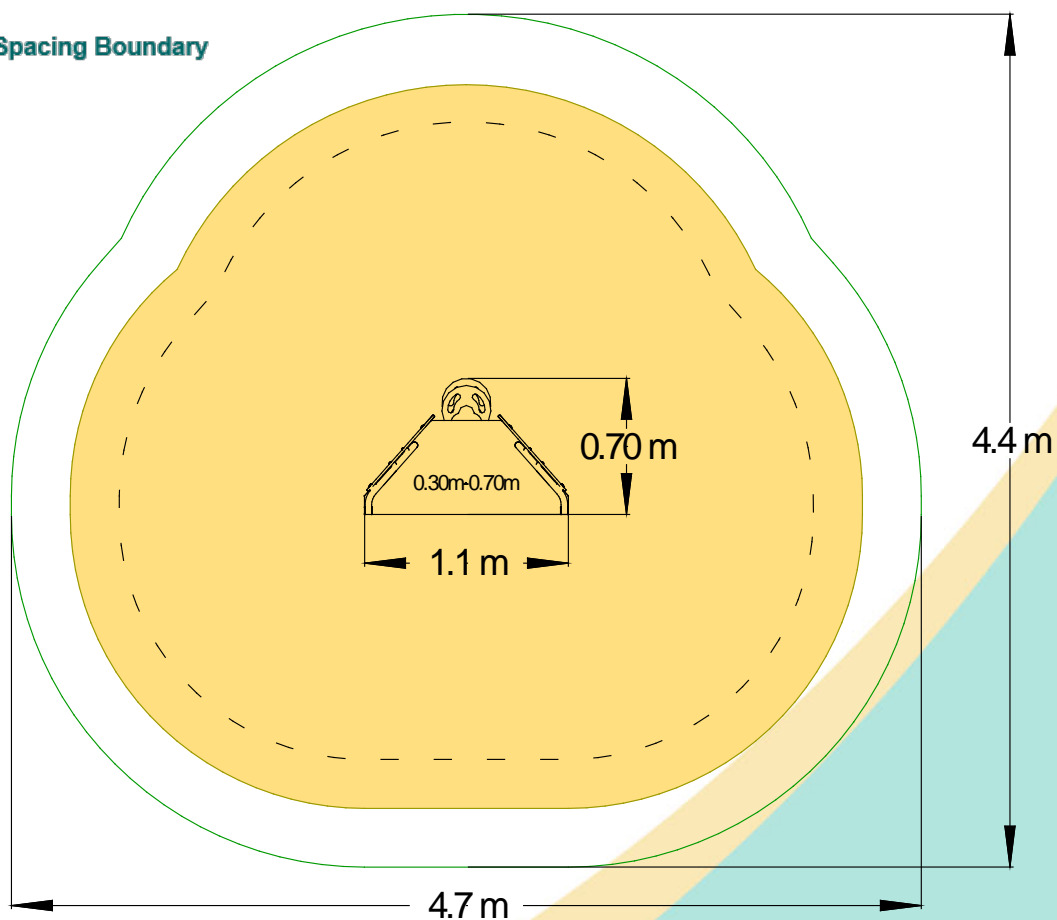
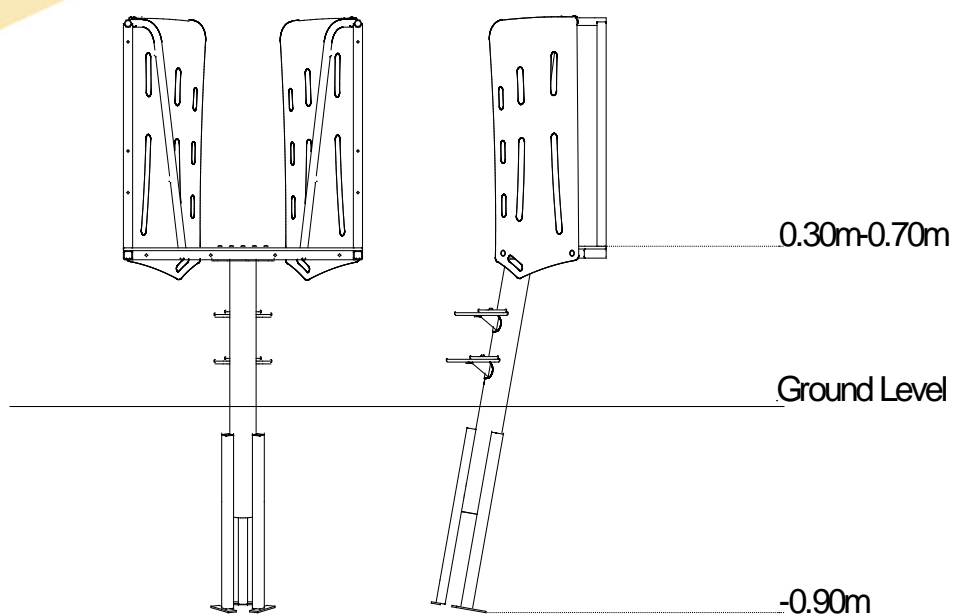

[Click here for more information & downloads](#) 

Versatile Embankment Slide

- Tower 1.1m High



Code - EM-TW(1.10)

Age

2-12 years dependent on frame height and slide length

Materials

Stainless Steel

Coloured CGL

Various Coloured Plastics

Product Description

Stainless Steel frame with CGL side panels and platform supported by solid stainless steel adjustable post. Innovative hand and foot steps made from textured CGL are attached to the adjustable post.

Technical Information

Equipment Dimensions

Length / Width / Height 1.1m x 1.04m x 0.5m

Surfacing and Area Required

Recommended Minimum Space L/W/H 4.4m x 4.7m x 3.6m

Max Gradient of Ground 1 in 5 at tower access

Free Height of Fall 1.1m

Impact Area 12m²

Synthetic Area (i.e. EPDM / Wet Pour / Synthetic Grass etc.) 12m²

Loosefill at 250mm depth (i.e. Bark / Cushionfall / Sand) 4m³

GrassLok Tiles (wear & tear) 2m²

Installation Information

SGF

Installation Time 2 Person(s) 1.5 Hour(s)

Overall Weight 79.5kg

Heaviest Part 16.4kg

Largest Part 0.48m x 1.04m x 0.04m

Longest Part 1.5m

Concrete Required 0.33m³

Conforms to EN 1176

[Click here for more information & downloads](#)



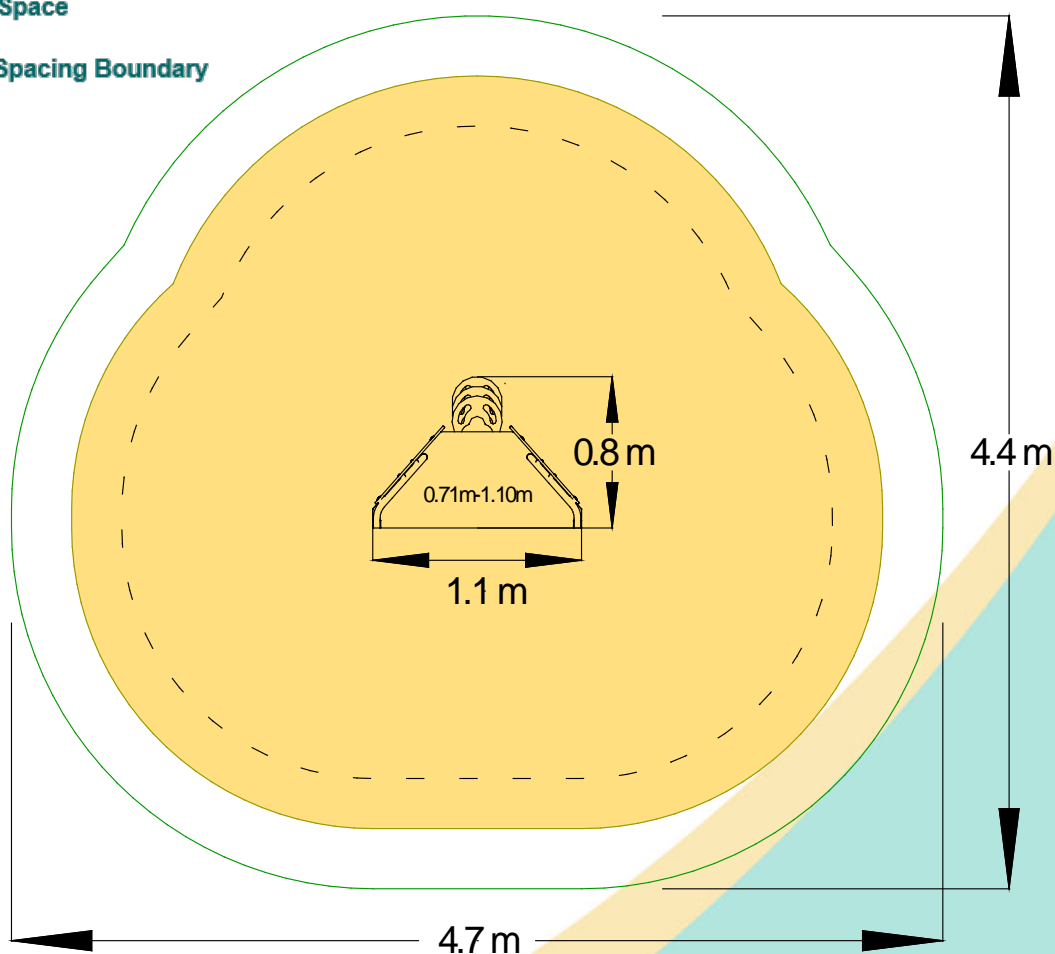
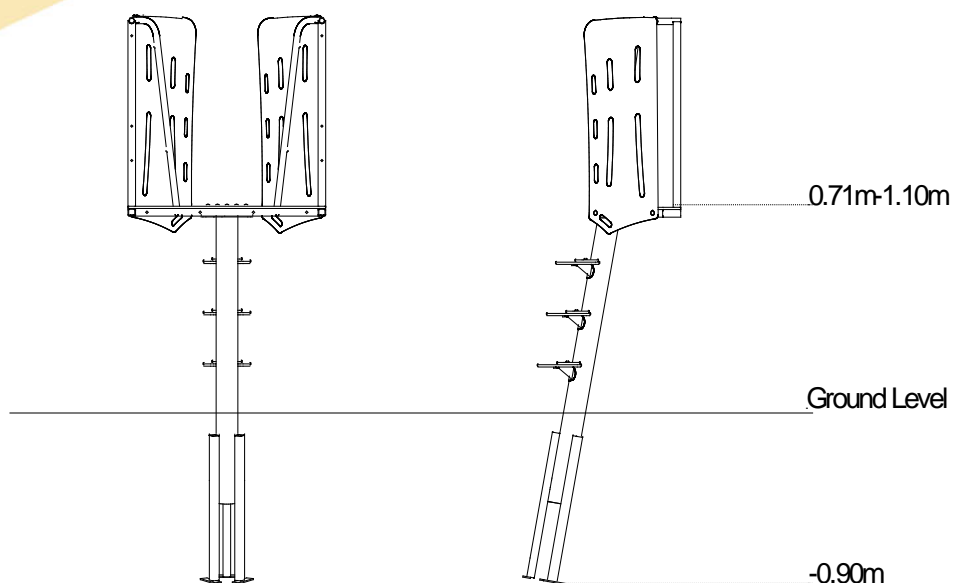

[Click here for more information & downloads](#) 

Versatile Embankment Slide

- Tower 1.5m High

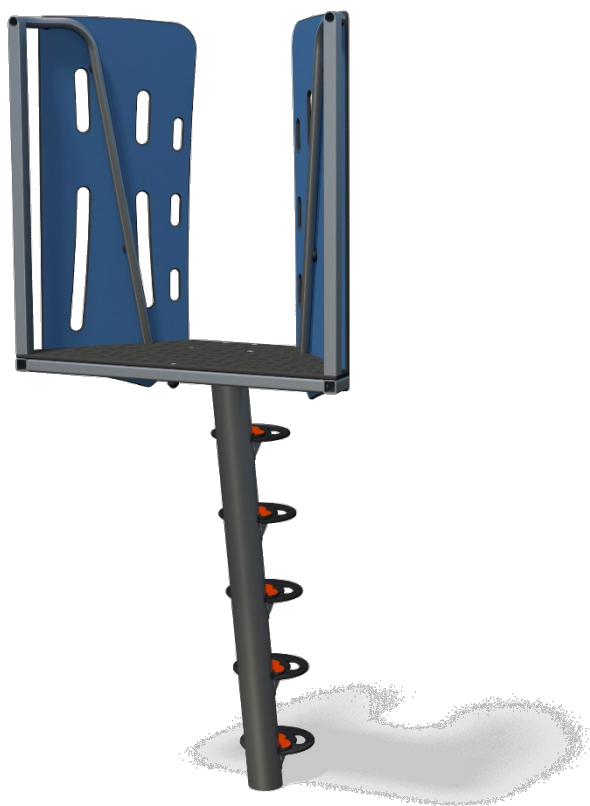

Code - EM-TW(1.50)

Age

2-12 years dependent on frame height and slide length

Materials

Stainless Steel

Coloured CGL

Various Coloured Plastics

Product Description

Stainless Steel frame with CGL side panels and platform supported by solid stainless steel adjustable post. Innovative hand and foot steps made from textured CGL are attached to the adjustable post.

Technical Information

Equipment Dimensions

Length / Width / Height 1.5m x 1.04m x 0.5m

Surfacing and Area Required

Recommended Minimum Space L/W/H 4.4m x 4.7m x 4.0m

Max Gradient of Ground 1 in 5 at tower access

Free Height of Fall 1.5m

Impact Area 12.3m²

Synthetic Area (i.e. EPDM / Wet Pour / Synthetic Grass etc.) 12.3m²

Loosefill at 250mm depth (i.e. Bark / Cushionfall / Sand) 4m³

GrassLok Tiles (wear & tear) 2m²

Installation Information

SGF

Installation Time 2 Person(s) 1.5 Hour(s)

Overall Weight 87.8kg

Heaviest Part 20.5kg

Largest Part 0.48m x 1.04m x 0.04m

Longest Part 1.9m

Concrete Required 0.33m³

Conforms to EN 1176

[Click here for more information & downloads](#)



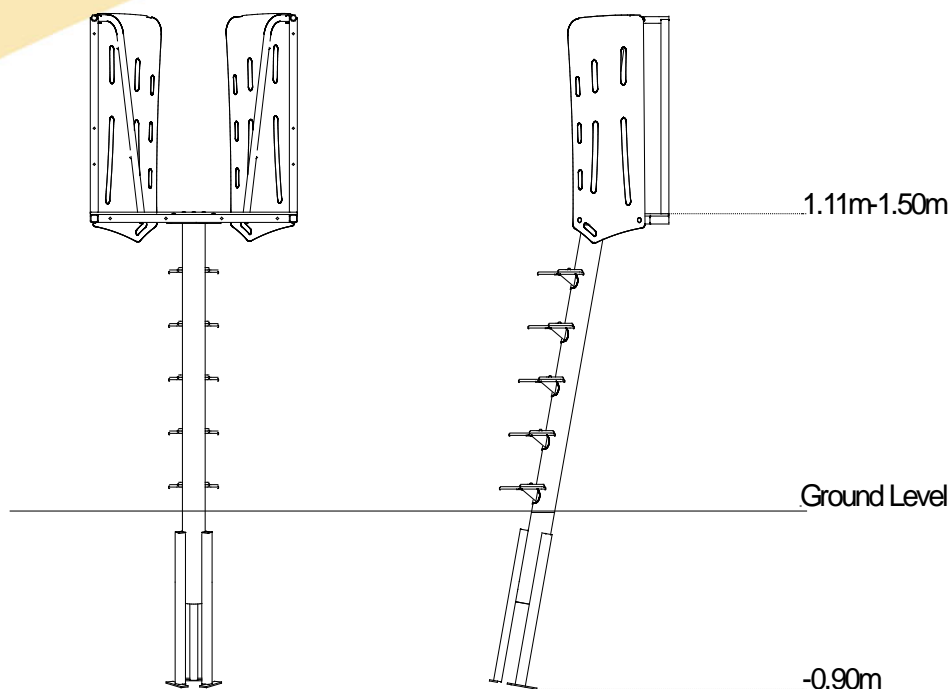

-  Recommended Minimum Space
-  Impact Area
-  Free Space
-  Unit Spacing Boundary

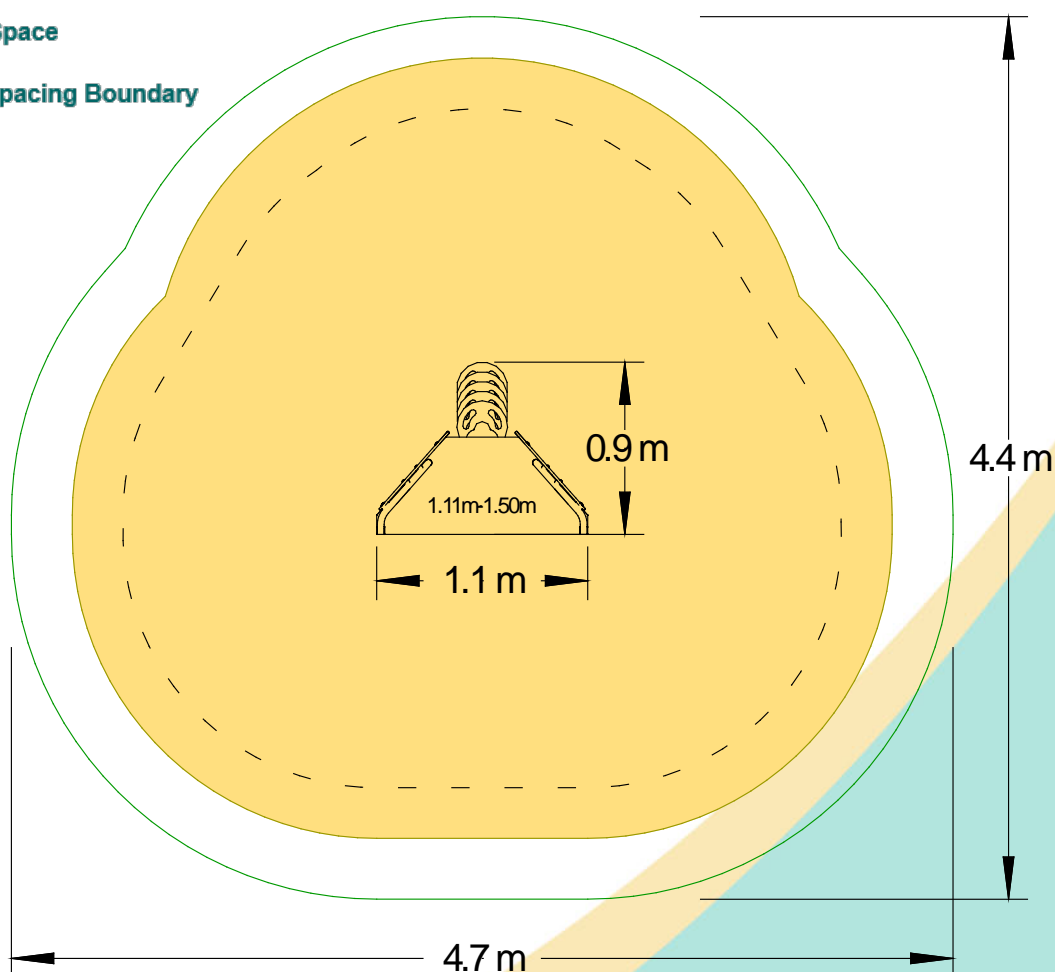

[Click here for more information & downloads](#) 

Versatile Embankment Slide

- Steel Wide 1.5m High

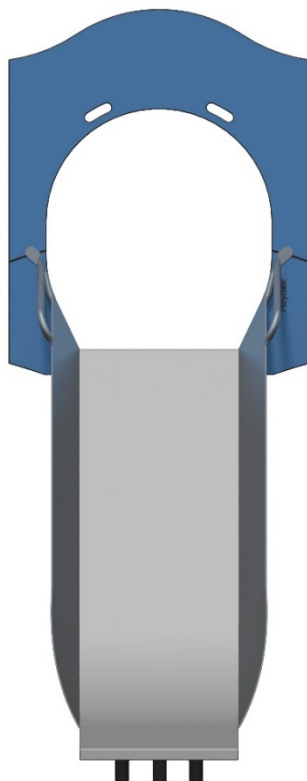

Code - EM-SW(1.50)

Age

2-12 years dependent on frame height and slide length

Materials

Stainless Steel

Coloured CGL

Various Coloured Plastics

Product Description

Stainless steel inclusive wide slide mounted to a coloured CGL frame, side panels and platform supported by solid stainless steel adjustable post. Innovative hand and foot steps made from textured CGL are attached to the adjustable post.

Technical Information

Equipment Dimensions

Length / Width / Height 2.3m x 3.1m x 1.0m

Surfacing and Area Required

Recommended Minimum Space L/W/H 4.4m x 4.4m x height dependant on tower used

Max Gradient of Ground 1 in 5 at runout

Free Height of Fall 1.0m at runout*

Impact Area 12.3m²

Synthetic Area (i.e. EPDM / Wet Pour / Synthetic Grass etc.) 10.4m²

Loosefill at 150mm depth (i.e. Bark / Cushionfall / Sand) 2m³

GrassLok Tiles (wear & tear) 4m²

Installation Information

SGF

Installation Time 2 Person(s) 1.5 Hour(s)

Overall Weight 105.3kg

Heaviest Part 53.3kg

Largest Part 1.5m x 0.5m x 3.3m

Longest Part 3.3m

Concrete Required 0.3m³

*The free height of fall could increase dependant on the angle of the embankment, the free height of fall can be measured from the sliding surface vertically down to the finished ground level.

Conforms to EN 1176

[Click here for more information & downloads](#)



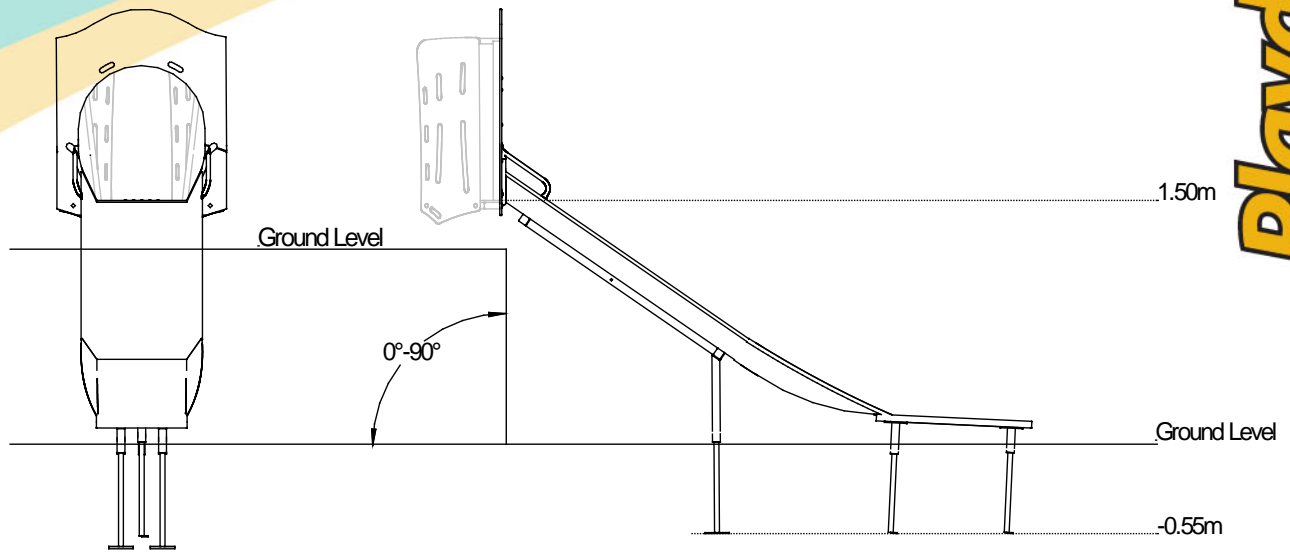

-  **Recommended Minimum Space**
-  **Impact Area**
-  **Free Space**
-  **Unit Spacing Boundary**

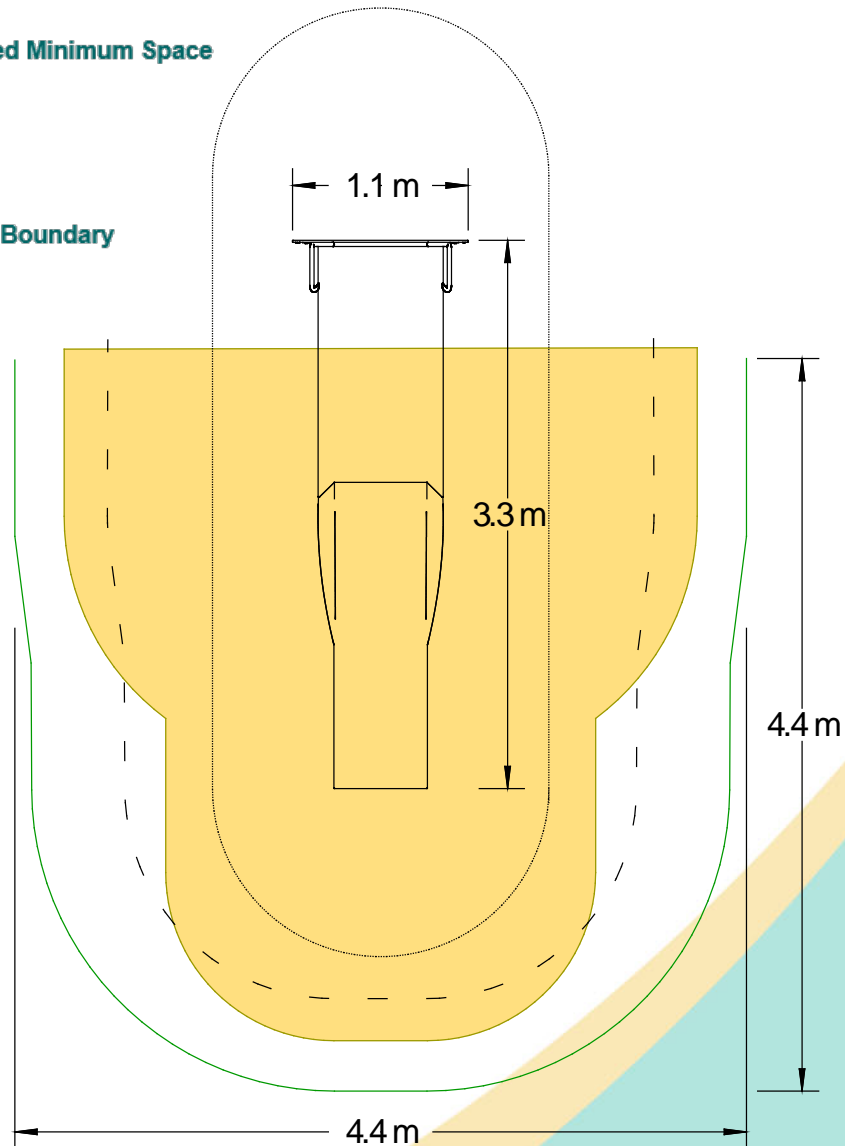

[Click here for more information & downloads](#) 

Versatile Embankment Slide

- Steel Wide 1.7m High

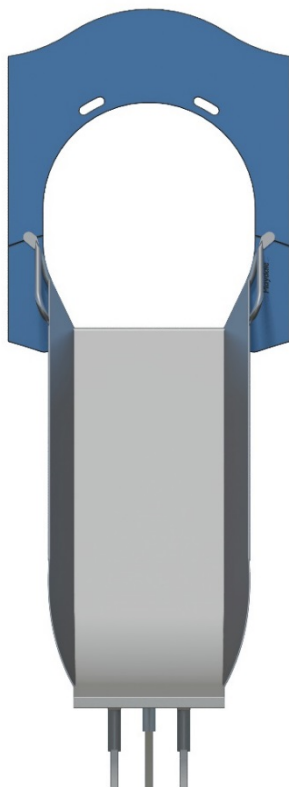

Code - EM-SW(1.70)

Age

2-12 years dependent on frame height and slide length

Materials

Stainless Steel

Coloured CGL

Various Coloured Plastics

Product Description

Stainless steel inclusive wide slide mounted to a coloured CGL frame, side panels and platform supported by solid stainless steel adjustable post. Innovative hand and foot steps made from textured CGL are attached to the adjustable post.

Technical Information

Equipment Dimensions

Length / Width / Height 2.5m x 3.3m x 1.0m

Surfacing and Area Required

Recommended Minimum Space L/W/H 4.4m x 4.4m x height dependant on tower used

Max Gradient of Ground 1 in 5 at runout

Free Height of Fall 1.0m at runout*

Impact Area 12.3m²

Synthetic Area (i.e. EPDM / Wet Pour / Synthetic Grass etc.) 10.4m²

Loosefill at 150mm depth (i.e. Bark / Cushionfall / Sand) 2m³

GrassLok Tiles (wear & tear) 4m²

Installation Information

SGF

Installation Time 2 Person(s) 1.5 Hour(s)

Overall Weight 105.3kg

Heaviest Part 53.3kg

Largest Part 1.5m x 0.5m x 3.3m

Longest Part 3.3m

Concrete Required 0.3m³

*The free height of fall could increase dependant on the angle of the embankment, the free height of fall can be measured from the sliding surface vertically down to the finished ground level.

Conforms to EN 1176

[Click here for more information & downloads](#)



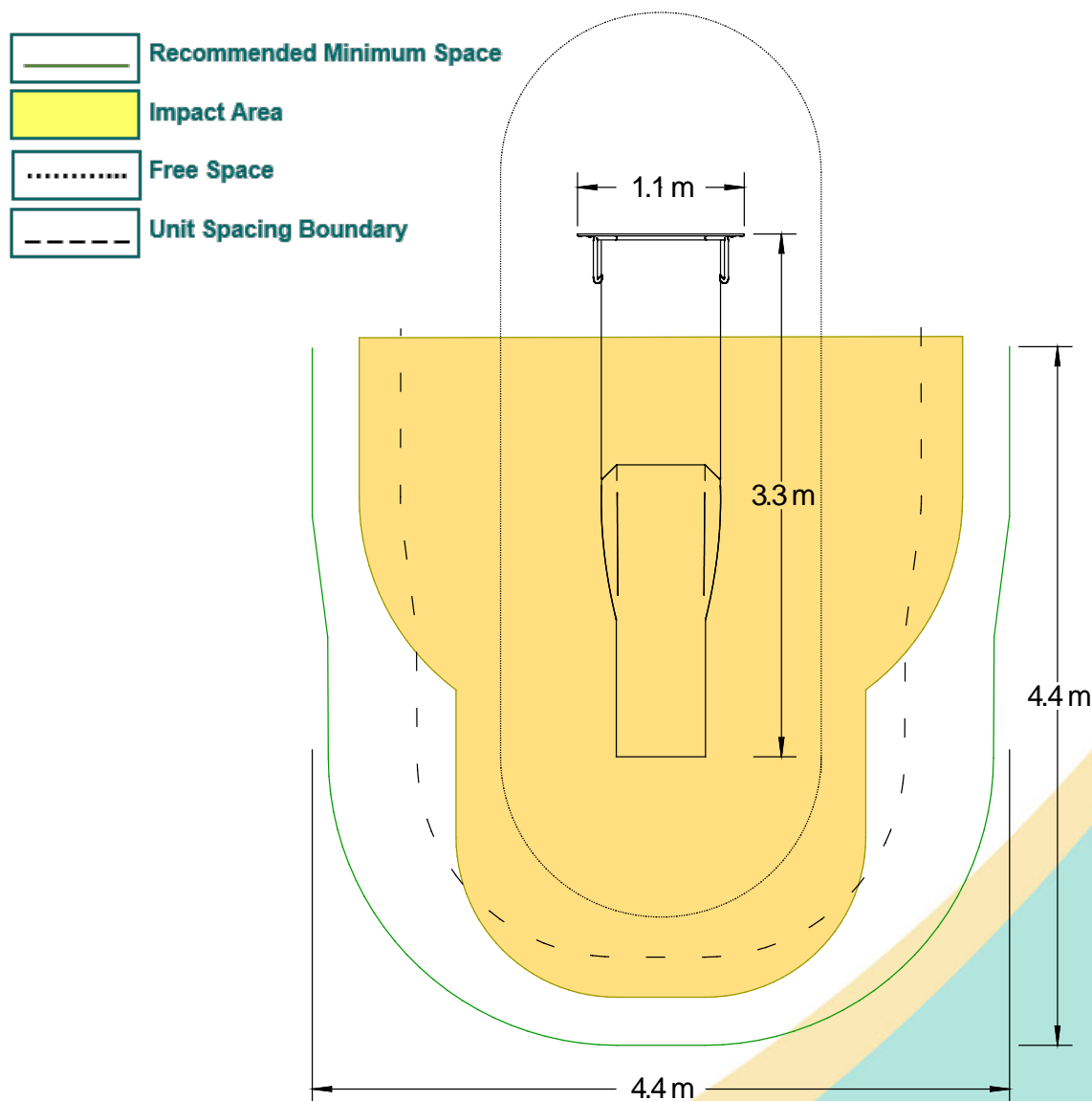
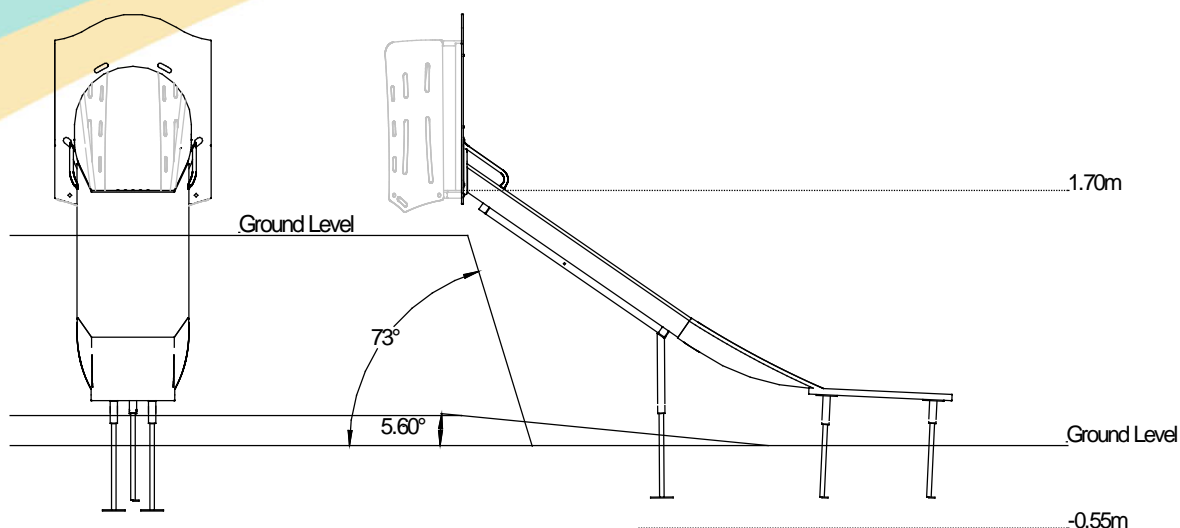

[Click here for more information & downloads](#)



Versatile Embankment Slide

- Steel Wide 1.9m High



Code - EM-SW(1.90)

Age

2-12 years dependent on frame height and slide length

Materials

Stainless Steel

Coloured CGL

Various Coloured Plastics

Product Description

Stainless steel inclusive wide slide mounted to a coloured CGL frame, side panels and platform supported by solid stainless steel adjustable post. Innovative hand and foot steps made from textured CGL are attached to the adjustable post.

Technical Information

Equipment Dimensions

Length / Width / Height 2.9m x 3.5m x 1.0m

Surfacing and Area Required

Recommended Minimum Space L/W/H 4.4m x 4.4m x height dependant on tower used

Max Gradient of Ground 1 in 5 at runout

Free Height of Fall 1.0m at runout*

Impact Area 13.4m²

Synthetic Area (i.e. EPDM / Wet Pour / Synthetic Grass etc.) 11.4m²

Loosefill at 150mm depth (i.e. Bark / Cushionfall / Sand) 3m³

GrassLok Tiles (wear & tear) 4m²

Installation Information

SGF

Installation Time 2 Person(s) 1.5 Hour(s)

Overall Weight 110.3kg

Heaviest Part 83.5kg

Largest Part 1.6m x 0.5m x 3.5m

Longest Part 3.5m

Concrete Required 0.3m³

*The free height of fall could increase dependant on the angle of the embankment, the free height of fall can be measured from the sliding surface vertically down to the finished ground level.

Conforms to EN 1176

[Click here for more information & downloads](#)



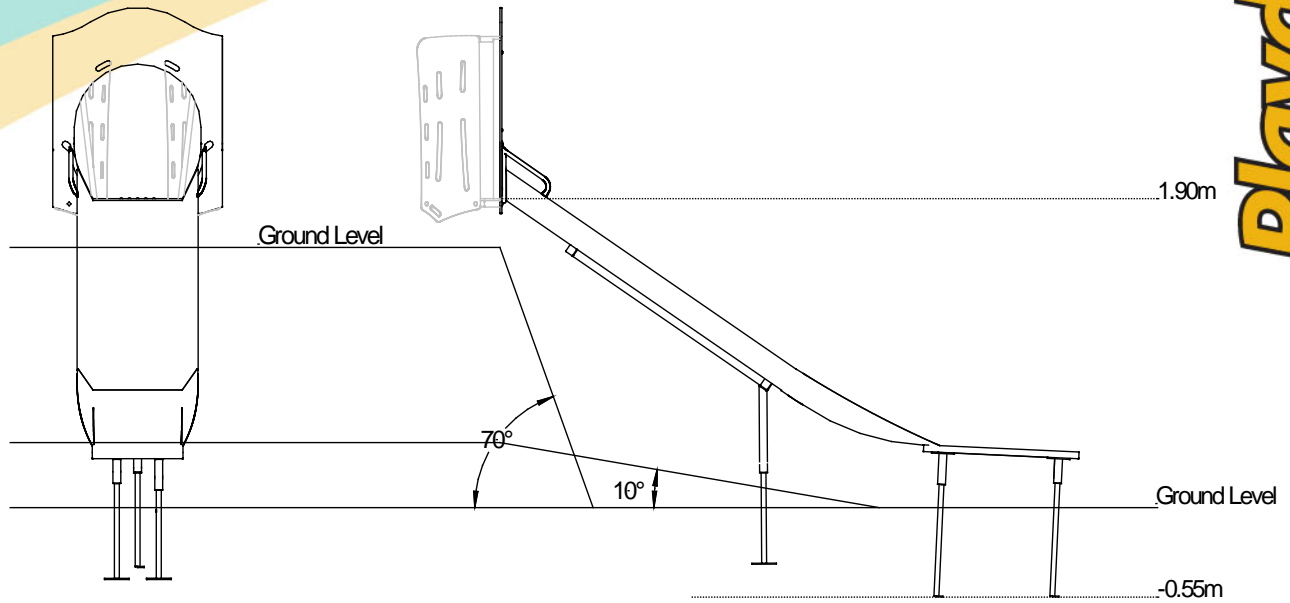

-  Recommended Minimum Space
-  Impact Area
-  Free Space
-  Unit Spacing Boundary

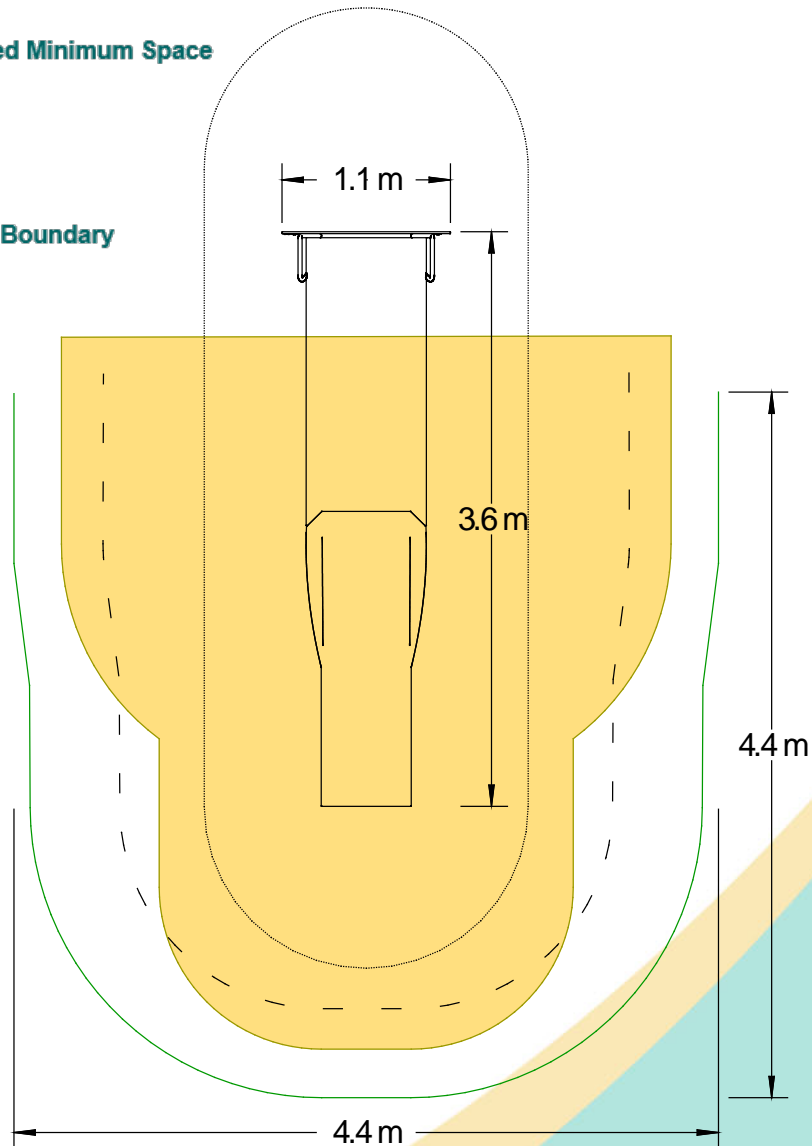

[Click here for more information & downloads](#) 

Versatile Embankment Slide

- Steel Wide 2.1m High

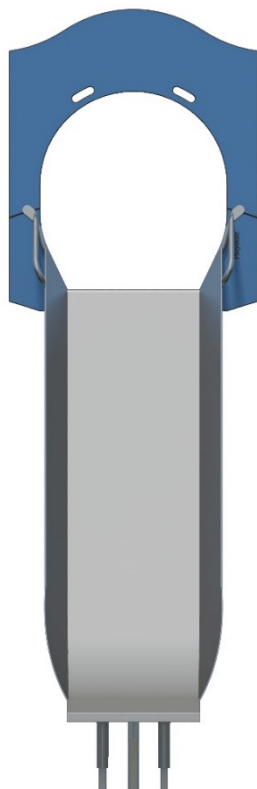

Code - EM-SW(2.10)

Age

2-12 years dependent on frame height and slide length

Materials

Stainless Steel

Coloured CGL

Various Coloured Plastics

Product Description

Stainless steel inclusive wide slide mounted to a coloured CGL frame, side panels and platform supported by solid stainless steel adjustable post. Innovative hand and foot steps made from textured CGL are attached to the adjustable post.

Technical Information

Equipment Dimensions

Length / Width / Height 3.2m x 4.1 x 1.0m

Surfing and Area Required

Recommended Minimum Space L/W/H 4.4m x 4.4m x height dependant on tower used

Max Gradient of Ground 1 in 5 at runout

Free Height of Fall 1.0m at runout*

Impact Area 15.6m²

Synthetic Area (i.e. EPDM / Wet Pour / Synthetic Grass etc.) 13.7m²

Loosefill at 150mm depth (i.e. Bark / Cushionfall / Sand) 3m³

GrassLok Tiles (wear & tear) 6m²

Installation Information

SGF

Installation Time 2 Person(s) 1.5 Hour(s)

Overall Weight 134kg

Heaviest Part 101.1kg

Largest Part 1.8m x 0.5m x 4.1m

Longest Part 4.1m

Concrete Required 0.3m³

*The free height of fall could increase dependant on the angle of the embankment, the free height of fall can be measured from the sliding surface vertically down to the finished ground level.

Conforms to EN 1176

[Click here for more information & downloads](#)



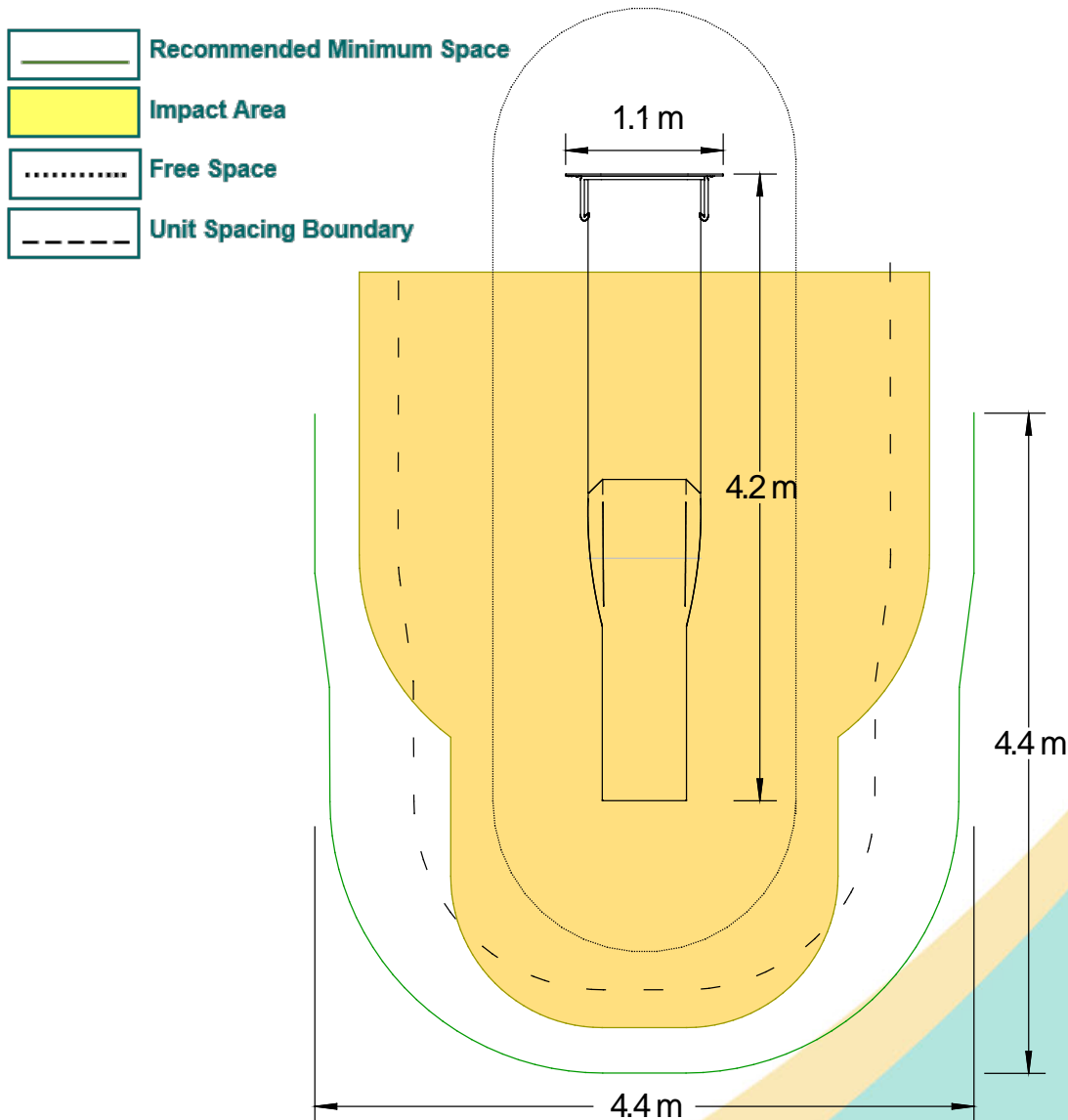
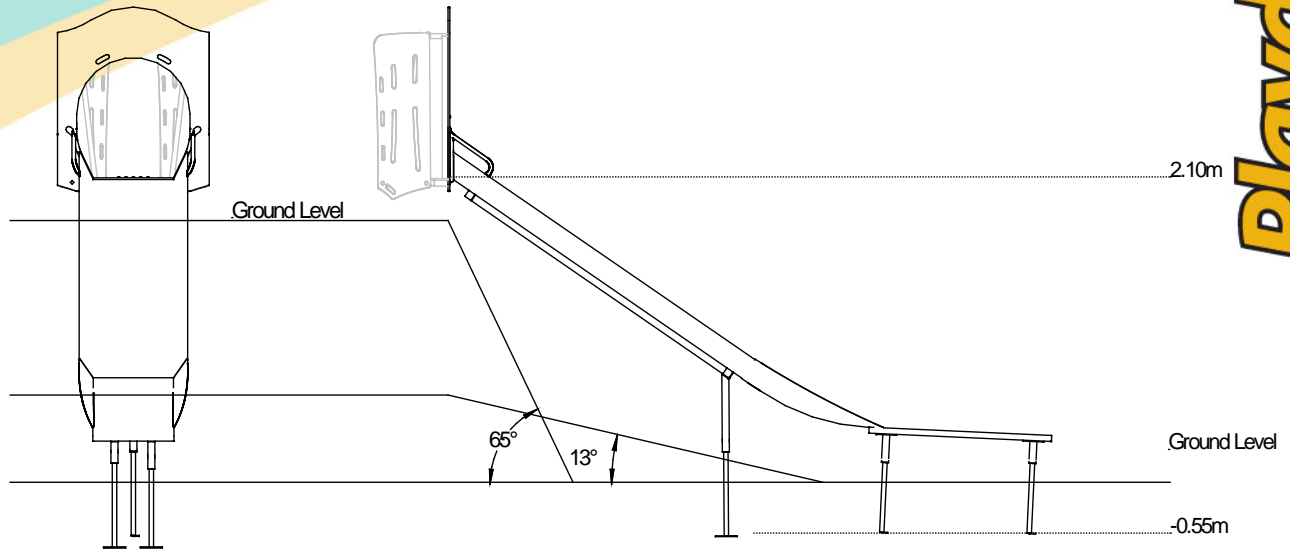

[Click here for more information & downloads](#) 

Versatile Embankment Slide

- Steel Wide 2.3m High

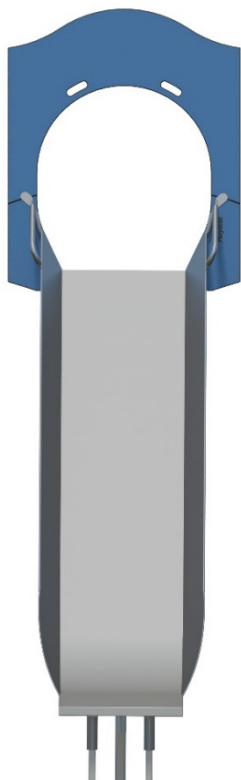

Code - EM-SW(2.30)

Age

2-12 years dependent on frame height and slide length

Materials

Stainless Steel

Coloured CGL

Various Coloured Plastics

Product Description

Stainless steel inclusive wide slide mounted to a coloured CGL frame, side panels and platform supported by solid stainless steel adjustable post. Innovative hand and foot steps made from textured CGL are attached to the adjustable post.

Technical Information

Equipment Dimensions

Length / Width / Height 3.5m x 4.4m x 1.0m

Surfacing and Area Required

Recommended Minimum Space L/W/H 5.5m x 4.4m x height dependant on tower used

Max Gradient of Ground 1 in 5 at runout

Free Height of Fall 1.0m at runout*

Impact Area 15.6m²

Synthetic Area (i.e. EPDM / Wet Pour / Synthetic Grass etc.) 13.7m²

Loosefill at 150mm depth (i.e. Bark / Cushionfall / Sand) 3m³

GrassLok Tiles (wear & tear) 6m²

Installation Information

SGF

Installation Time 2 Person(s) 1.5 Hour(s)

Overall Weight 139.3kg

Heaviest Part 106.3kg

Largest Part 1.9m x 0.5m x 4.4m

Longest Part 4.4m

Concrete Required 0.3m³

*The free height of fall could increase dependant on the angle of the embankment, the free height of fall can be measured from the sliding surface vertically down to the finished ground level.

Conforms to EN 1176

[Click here for more information & downloads](#)



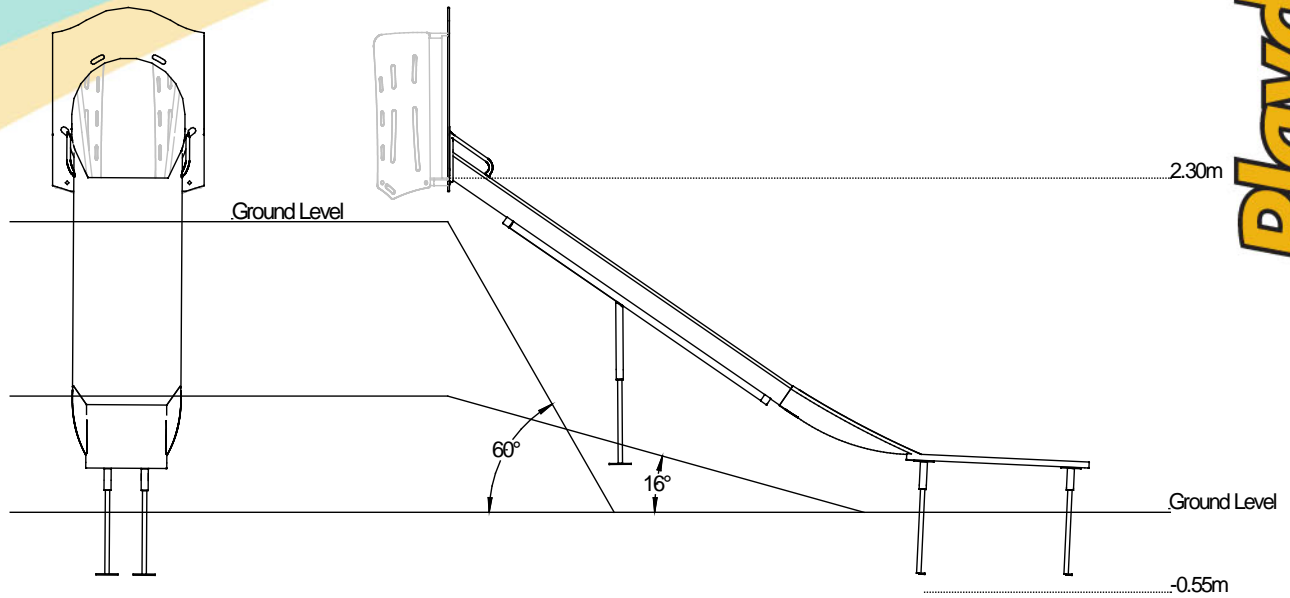

-  Recommended Minimum Space
-  Impact Area
-  Free Space
-  Unit Spacing Boundary

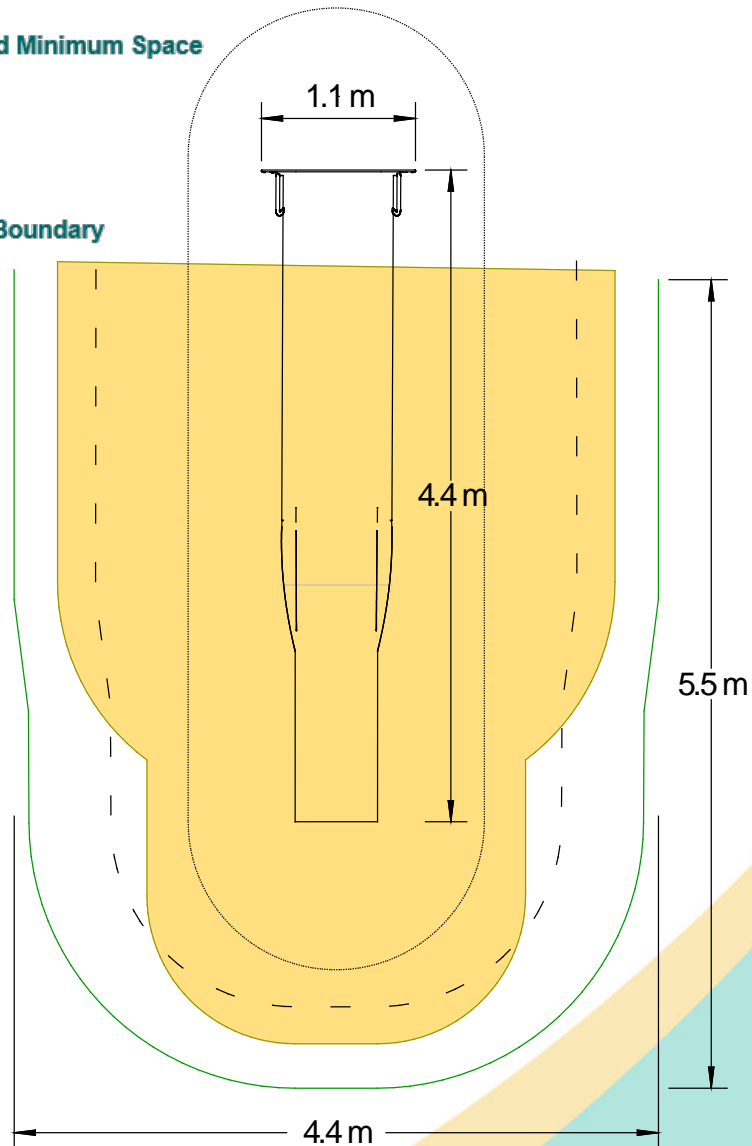

[Click here for more information & downloads](#) 

Versatile Embankment Slide

- Steel Wide 2.5m High

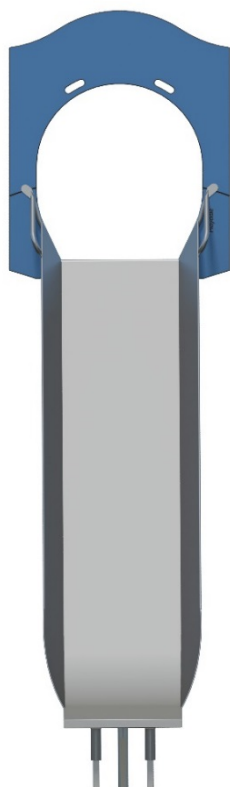

Code - EM-SW(2.50)

Age

2-12 years dependent on frame height and slide length

Materials

Stainless Steel

Coloured CGL

Various Coloured Plastics

Product Description

Stainless steel inclusive wide slide mounted to a coloured CGL frame, side panels and platform supported by solid stainless steel adjustable post. Innovative hand and foot steps made from textured CGL are attached to the adjustable post.

Technical Information

Equipment Dimensions

Length / Width / Height 3.6m x 4.7m x 1.0m

Surfacing and Area Required

Recommended Minimum Space L/W/H 4.4m x 4.4m x height dependant on tower used

Max Gradient of Ground 1 in 5 at runout

Free Height of Fall 1.0m at runout*

Impact Area 17.8m²

Synthetic Area (i.e. EPDM / Wet Pour / Synthetic Grass etc.) 15.8m²

Loosefill at 150mm depth (i.e. Bark / Cushionfall / Sand) 3m³

GrassLok Tiles (wear & tear) 6m²

Installation Information

SGF

Installation Time 2 Person(s) 1.5 Hour(s)

Overall Weight 153.7kg

Heaviest Part 116.7kg

Largest Part 2.0m x 0.5m x 4.7m

Longest Part 4.7m

Concrete Required 0.3m³

*The free height of fall could increase dependant on the angle of the embankment, the free height of fall can be measured from the sliding surface vertically down to the finished ground level.

Conforms to EN 1176

[Click here for more information & downloads](#)



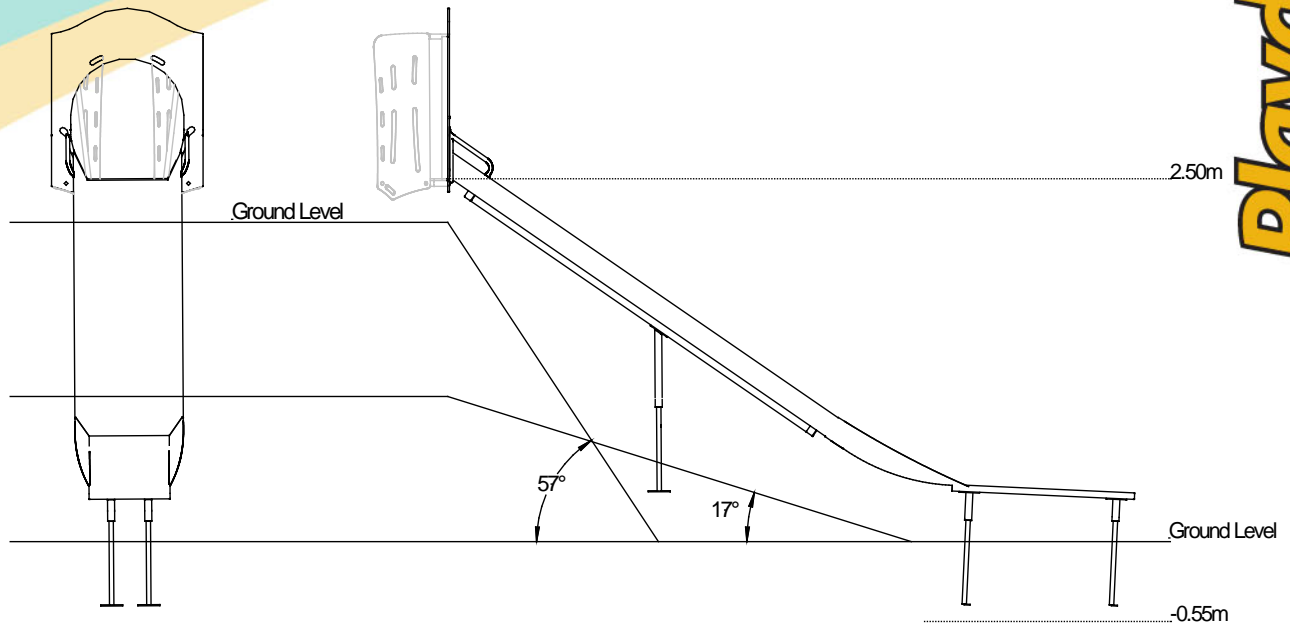

-  Recommended Minimum Space
-  Impact Area
-  Free Space
-  Unit Spacing Boundary

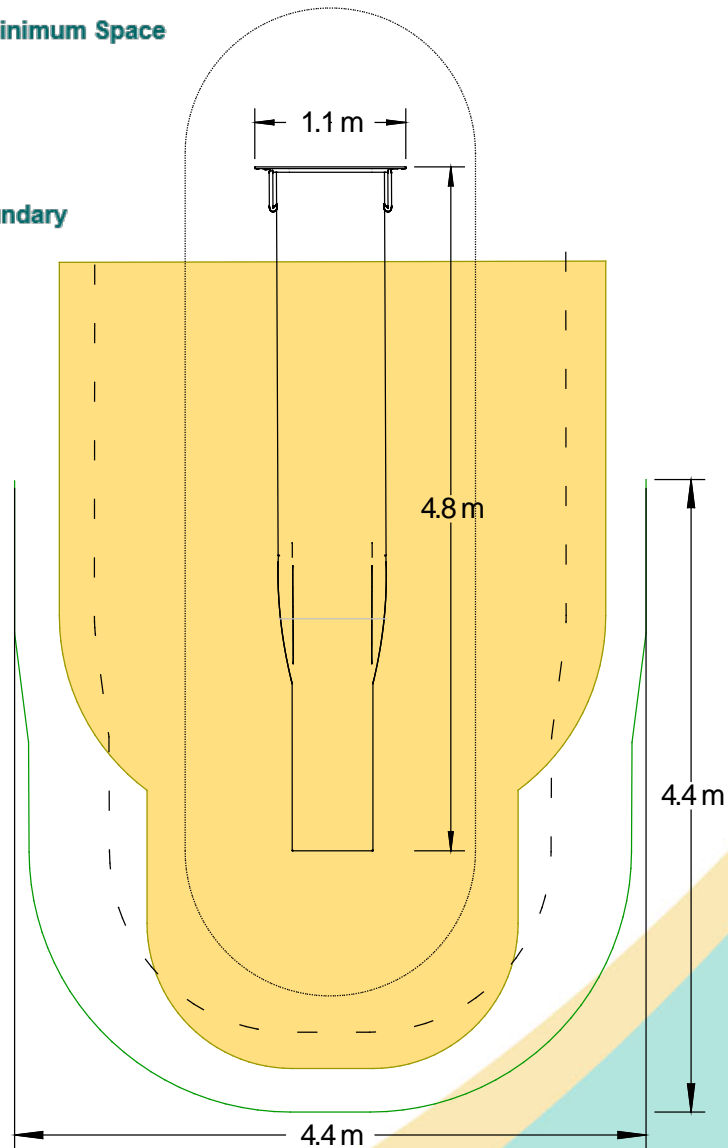

[Click here for more information & downloads](#) 

Versatile Embankment Slide

- Steel Wide 2.7m High

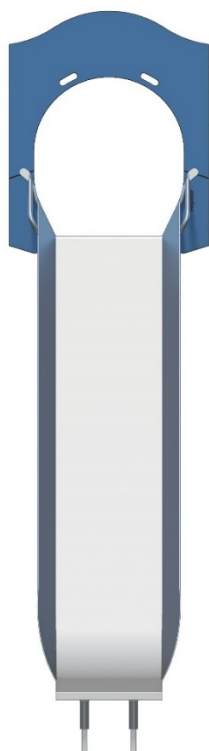

Code - EM-SW(2.70)

Age

2-12 years dependent on frame height and slide length

Materials

Stainless Steel

Coloured CGL

Various Coloured Plastics

Product Description

Stainless steel inclusive wide slide mounted to a coloured CGL frame, side panels and platform supported by solid stainless steel adjustable post. Innovative hand and foot steps made from textured CGL are attached to the adjustable post.

Technical Information

Equipment Dimensions

Length / Width / Height 3.8m x 5.2m x 1.0m

Surfacing and Area Required

Recommended Minimum Space L/W/H 6.3m x 4.4m x height dependant on tower used

Max Gradient of Ground 1 in 5 at runout

Free Height of Fall 1.0m at runout*

Impact Area 19.6m²

Synthetic Area (i.e. EPDM / Wet Pour / Synthetic Grass etc.) 17.6m²

Loosefill at 150mm depth (i.e. Bark / Cushionfall / Sand) 4m³

GrassLok Tiles (wear & tear) 6m²

Installation Information

SGF

Installation Time 2 Person(s) 1.5 Hour(s)

Overall Weight 161.2kg

Heaviest Part 124.1kg

Largest Part 2.3m x 0.5m x 5.2m

Longest Part 5.2m

Concrete Required 0.3m³

*The free height of fall could increase dependant on the angle of the embankment, the free height of fall can be measured from the sliding surface vertically down to the finished ground level.

Conforms to EN 1176

[Click here for more information & downloads](#)



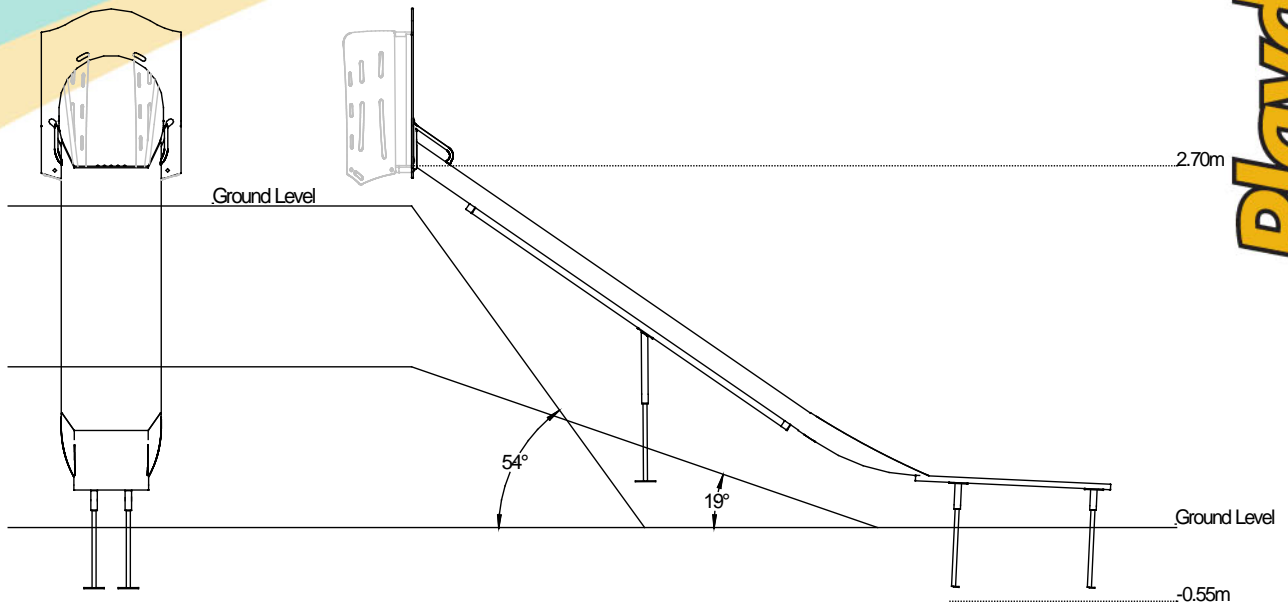

-  Recommended Minimum Space
-  Impact Area
-  Free Space
-  Unit Spacing Boundary

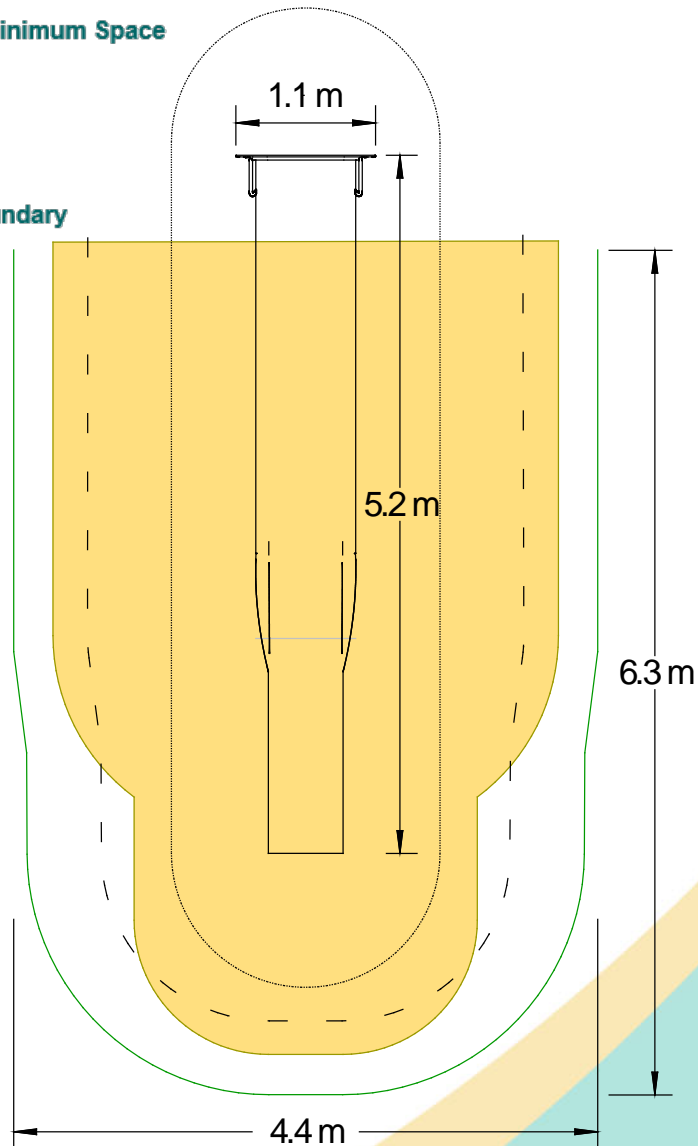

[Click here for more information & downloads](#) 